

ELEVATE

YOUR BUSINESS: OWN
THE 20TH FLOOR @1100 ALAKEA



RARE OPPORTUNITY TO OWN a prestigious high-floor office space in the heart of Honolulu's Central Business District.

- ▲ UNMATCHED Mountain, Ocean and City Views
- ▲ PRESTIGIOUS Office Condo in the Heart of Honolulu
- ▲ 12 Reserved Covered Stalls: C319, C320, C321, C574/C575, C577/C578, C624, S331/S332, S461, S462
- ▲ CONVENIENCE: 1100 Alakea is on the corner of Hotel and Alakea Streets, directly across from the District Court, Ali'i Place, Bishop Square and the State Capitol and Iolani Palace are just a short walk away.
- ▲ EASY ACCESS TO & FROM Downtown Honolulu: Entry and exit at the top of Bishop and Alakea Streets
- ▲ Elevator use is subject to owner discretion.

PRICE: \$2,888,942.00

SIZE: 6,053 SF

TENURE: FEE SIMPLE

YEAR BUILT: 1993

ZONING: BMX-4

COVERED PARKING STALLS:
12 Reserved

TMK: #1-2-1-10-5-39

CAM: \$1.43/RSF (2025)

REAL PROPERTY TAX:
\$0.43/SF



1100 ALAKEA STREET

FEE SIMPLE | 20TH FLOOR | HONOLULU, HI 96813



**Hawaii
Commercial
Real Estate**
hawaiiCRE.com



VICTOR ARCAYENA (S)
Senior Vice President
HI LIC #RS-70259
victor@hawaiiCRE.com
(808) 292-9154



RYLAND HART (S)
Sales/Leasing
HI LIC #RS-87807
ryland@hawaiiCRE.com
(808) 499-4801



HEY HO (S)
Sales/Leasing
HI LIC #RS-87274
Hey@hawaiiCRE.com
(808) 201-2288

Posted 11/12/25. The information presented was obtained from sources believed reliable. While we do not doubt its accuracy, we have not verified it and make no guarantee, warranty or representation about it.

1100 ALAKEA STREET

FEE SIMPLE | 20TH FLOOR | HONOLULU, HI 96813

ELEVATE

YOUR BUSINESS: OWN
THE 20TH FLOOR @1100 ALAKEA



THE VIEWS: This exclusive high-floor suite offers breathtaking, unobstructed views of the mountains, city skyline, and ocean. Enjoy panoramic vistas of iconic landmarks including the State Capitol, Iolani Palace, and the historic architecture of the capital district.



FOCUS+
EXPERIENCE
= RESULTS



Posted 11/12/25. The information presented was obtained from sources believed reliable. While we do not doubt its accuracy, we have not verified it and make no guarantee, warranty or representation about it.



**Hawaii
Commercial
Real Estate**
hawaiiCRE.com



VICTOR ARCAYENA (S)
Senior Vice President
HI LIC #RS-70259
victor@hawaiiCRE.com
(808) 292-9154



RYLAND HART (S)
Sales/Leasing
HI LIC #RS-87807
ryland@hawaiiCRE.com
(808) 499-4801



HEY HO (S)
Sales/Leasing
HI LIC #RS-87274
Hey@hawaiiCRE.com
(808) 201-2288

ELEVATE

YOUR BUSINESS: OWN
THE 20TH FLOOR @1100 ALAKEA



1100 ALAKEA STREET

FEE SIMPLE | 20TH FLOOR | HONOLULU, HI 96813



STRATEGIC LOCATION at the corner of Hotel and Alakea Streets, the property is directly across from the District Court, Ali'i Place, and Bishop Square. The State Capitol and I'olani Palace are just a short walk away, making this location ideal for professionals seeking proximity to Honolulu's civic and business centers.



VICTOR ARCA YENA (S)
Senior Vice President
HI LIC #RS-70259
victor@hawaiiCRE.com
(808) 292-9154

RYLAND HART (S)
Sales/Leasing
HI LIC #RS-87807
ryland@hawaiiCRE.com
(808) 499-4801

HEY HO (S)
Sales/Leasing
HI LIC #RS-87274
Hey@hawaiiCRE.com
(808) 201-2288



Posted 11/12/25. The information presented was obtained from sources believed reliable. While we do not doubt its accuracy, we have not verified it and make no guarantee, warranty or representation about it.

ELEVATE

YOUR BUSINESS: OWN
THE 20TH FLOOR @ 1100 ALAKEA

1100 ALAKEA STREET
FEE SIMPLE | 20TH FLOOR | HONOLULU, HI 96813

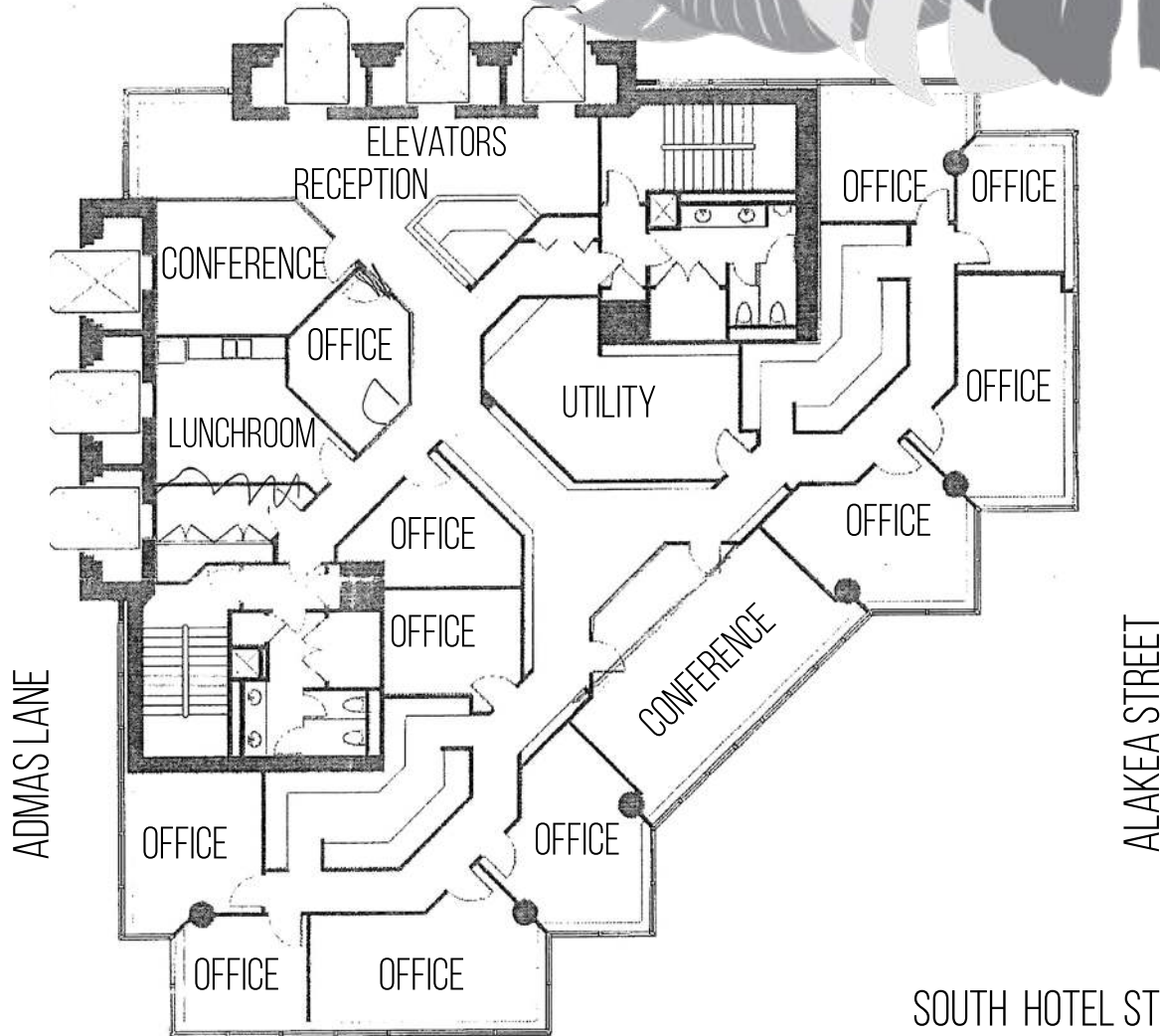

FLOOR PLAN 20TH FLOOR

Rare opportunity to acquire the entire 20th floor of 1100 Alakea Street—a premier Class A, Fee Simple commercial office condominium located in the heart of Downtown Honolulu.



**Hawaii
Commercial
Real Estate**
hawaiicre.com



VICTOR ARCAYENA (S)
Senior Vice President
HI LIC #RS-70259
victor@hawaiicre.com
(808) 292-9154



RYLAND HART (S)
Sales/Leasing
HI LIC #RS-87807
ryland@hawaiicre.com
(808) 499-4801



HEY HO (S)
Sales/Leasing
HI LIC #RS-87274
Hey@hawaiicre.com
(808) 201-2288



FOCUS+
EXPERIENCE
= RESULTS



Posted 11/12/25. The information presented was obtained from sources believed reliable. While we do not doubt its accuracy, we have not verified it and make no guarantee, warranty or representation about it.

ELEVATE

YOUR BUSINESS: OWN THE 20TH FLOOR @ 1100 ALAKEA

1100 ALAKEA STREET

FEE SIMPLE | 20TH FLOOR | HONOLULU, HI 96813



PARKING LEVEL - 3

With convenient ingress and egress from Bishop and Alakea Streets, commuting is streamlined—saving valuable time when entering or exiting Downtown.

12 RESERVED COVERED STALLS:
C319, C320, C321, C574/C575, C577/
C578, C624, S331/S332, S461, S462



**Hawaii
Commercial
Real Estate**
hawaiiCRE.com



VICTOR ARCAYENA (S)
Senior Vice President
HI LIC #RS-70259
victor@hawaiiCRE.com
(808) 292-9154



RYLAND HART (S)
Sales/Leasing
HI LIC #RS-87807
ryland@hawaiiCRE.com
(808) 499-4801



HEY HO (S)
Sales/Leasing
HI LIC #RS-87274
Hey@hawaiiCRE.com
(808) 201-2288



FOCUS+
EXPERIENCE
= RESULTS



Posted 11/12/25. The information presented was obtained from sources believed reliable. While we do not doubt its accuracy, we have not verified it and make no guarantee, warranty or representation about it.

ELEVATE

YOUR BUSINESS: OWN THE 20TH FLOOR @1100 ALAKEA

1100 ALAKEA STREET

FEE SIMPLE | 20TH FLOOR | HONOLULU, HI 96813



PARKING LEVEL - 4

With convenient ingress and egress from Bishop and Alakea Streets, commuting is streamlined—saving valuable time when entering or exiting Downtown.

12 RESERVED COVERED STALLS:
C319, C320, C321, C574/C575, C577/
C578, C624, S331/S332, S461, S462



**Hawaii
Commercial
Real Estate**
hawaiiCRE.com



VICTOR ARCAYENA (S)
Senior Vice President
HI LIC #RS-70259
victor@hawaiiCRE.com
(808) 292-9154



RYLAND HART (S)
Sales/Leasing
HI LIC #RS-87807
ryland@hawaiiCRE.com
(808) 499-4801



HEY HO (S)
Sales/Leasing
HI LIC #RS-87274
Hey@hawaiiCRE.com
(808) 201-2288



FOCUS+
EXPERIENCE
= RESULTS



Posted 11/12/25. The information presented was obtained from sources believed reliable. While we do not doubt its accuracy, we have not verified it and make no guarantee, warranty or representation about it.

ELEVATE YOUR BUSINESS: OWN THE 20TH FLOOR @1100 ALAKEA

1100 ALAKEA STREET
 FEE SIMPLE | 20TH FLOOR | HONOLULU, HI 96813

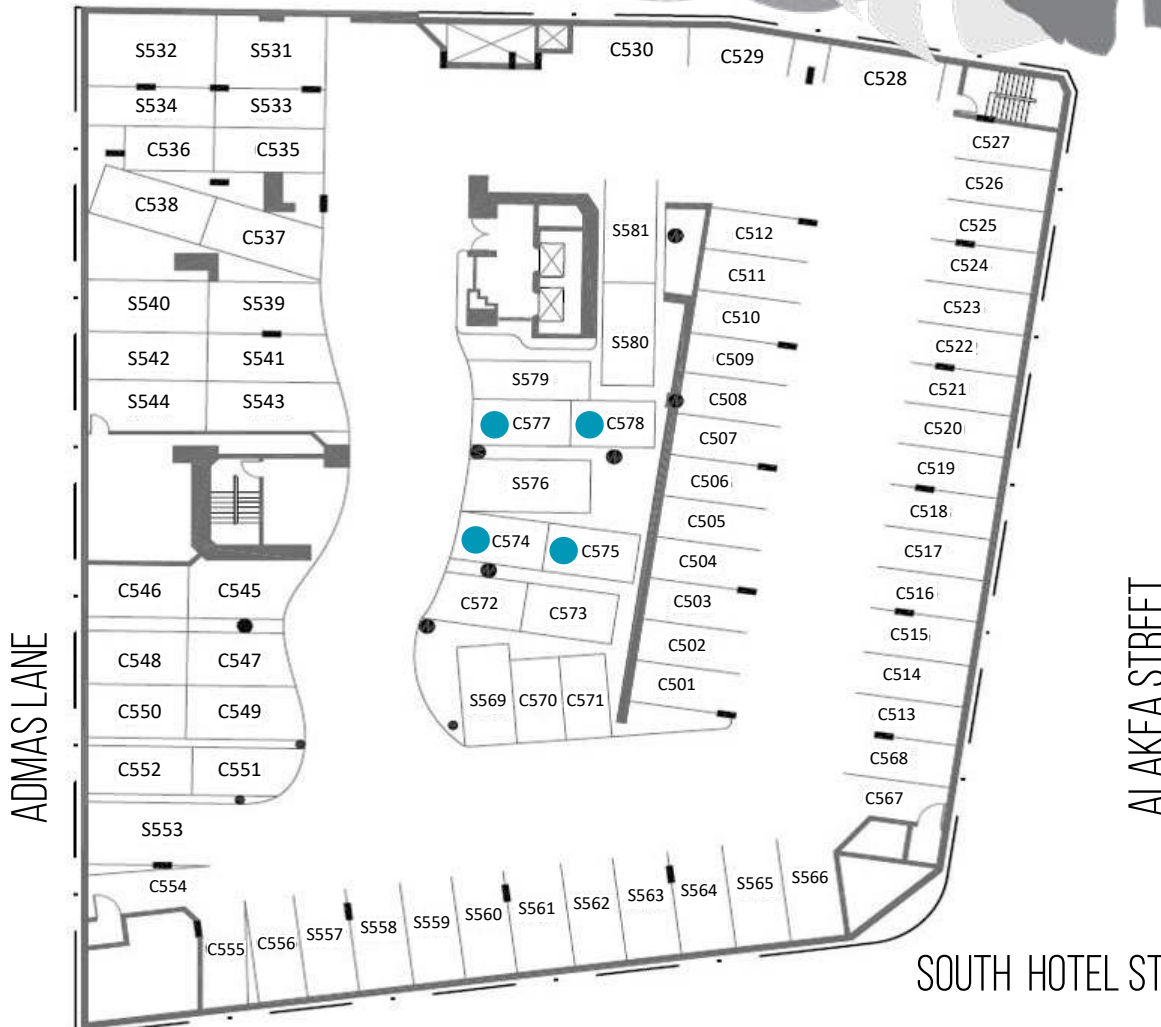

PARKING LEVEL - 5

With convenient ingress and egress from Bishop and Alakea Streets, commuting is streamlined—saving valuable time when entering or exiting Downtown.

12 RESERVED COVERED STALLS:
 C319, C320, C321, C574/C575, C577/
 C578, C624, S331/S332, S461, S462



VICTOR ARCA YENA (S)
 Senior Vice President
 HI LIC #RS-70259
 victor@hawaiiacre.com
 (808) 292-9154

RYLAND HART (S)
 Sales/Leasing
 HI LIC #RS-87807
 ryland@hawaiiacre.com
 (808) 499-4801

HEY HO (S)
 Sales/Leasing
 HI LIC #RS-87274
 Hey@hawaiiacre.com
 (808) 201-2288



FOCUS+
 EXPERIENCE
 = RESULTS



Posted 11/12/25. The information presented was obtained from sources believed reliable. While we do not doubt its accuracy, we have not verified it and make no guarantee, warranty or representation about it.

ELEVATE

YOUR BUSINESS: OWN
THE 20TH FLOOR @ 1100 ALAKEA

1100 ALAKEA STREET
FEE SIMPLE | 20TH FLOOR | HONOLULU, HI 96813

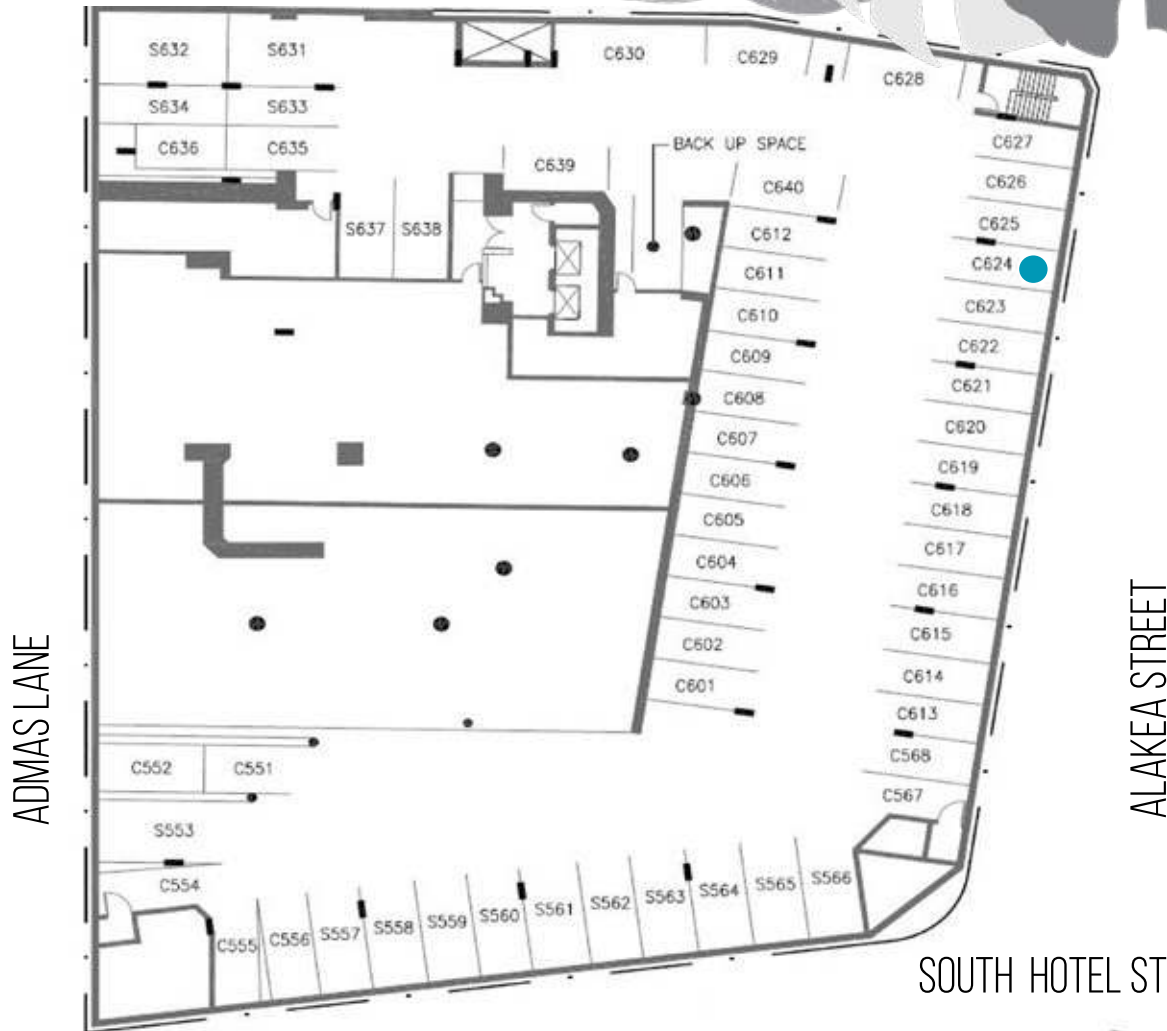

PARKING LEVEL - 6

With convenient ingress and egress from Bishop and Alakea Streets, commuting is streamlined—saving valuable time when entering or exiting Downtown.

12 RESERVED COVERED STALLS:
C319, C320, C321, C574/C575, C577/
C578, C624, S331/S332, S461, S462



**Hawaii
Commercial
Real Estate**
hawaiiCRE.com



VICTOR ARCAYENA (S)
Senior Vice President
HI LIC #RS-70259
victor@hawaiiCRE.com
(808) 292-9154



RYLAND HART (S)
Sales/Leasing
HI LIC #RS-87807
ryland@hawaiiCRE.com
(808) 499-4801



HEY HO (S)
Sales/Leasing
HI LIC #RS-87274
Hey@hawaiiCRE.com
(808) 201-2288



FOCUS+
EXPERIENCE
= RESULTS



Posted 11/12/25. The information presented was obtained from sources believed reliable. While we do not doubt its accuracy, we have not verified it and make no guarantee, warranty or representation about it.