

CLASS A OFFICE SPACE - URBAN OASIS

QUEEN'S COURT | 800 Bethel Street, Suite 401, Honolulu, HI 96813



RARE - FEE SIMPLE

SUITE 401

Class A Office: 1,320 SF

Exclusive Lanai: 187 SF

2 Parking Stalls

- P4-28 (C)
- P11-20 (S)

TMK (1) 2-1-2-26:10

ASKING \$808,000 FS

- Seller Financing Available to well qualified buyer

**Price
Reduced by
\$50 K**
Was \$858,000

Ideal for Owner-User with two (2) parking stalls in Harbor Court. High-end finishes throughout the Suite with expansive floor to ceiling windows, featuring breathtaking views of the Pacific Ocean, creating an urban oasis in Downtown Honolulu.

- 10' ceilings
- Large loading dock
- Three levels of security:
- Main Gate | Entry/Elevator | Studio
- Additional monthly staff parking available at Harbor Court



www.hawaiiCRE.com

VICTOR ARCAJENA, RS-70259

Vice President

808-292-9154

victor@hawaiiCRE.com

TAYLOR Y. HIGA, RS-86404

Associate

808-260-6441

taylor@hawaiiCRE.com

Please note: the information above has been obtained from sources believed reliable. While we do not doubt its accuracy, we have not verified it and make no guarantee, warranty or representation about it. Posted 11/03/24

CLASS A OFFICE SPACE - URBAN OASIS

QUEEN'S COURT | 800 Bethel Street, Suite 401, Honolulu, HI 96813

LOCATION

Superior location in Honolulu's Central Business District, only a few steps from famous Chinatown. Close to world class dining, shopping and ocean sports. Public transportation within steps. Located at the corner of Nimitz Highway and Bethel Street, with easy access to H-1, Ala Moana and the Honolulu Airport.



AMENITIES

3 MILE RADIUS

Eating & Drinking Places: 1,039

Arts/Entertainment/Recreation: 240

Apparel & Accessory Stores: 312

*SOURCE: Copyright 2021 Data Axle, Inc. All rights reserved. Esri Total Residential Population forecasts for 2021. Note: Data on the Business Summary report is calculated using Esri's Data allocation method which uses census block groups to allocate business summary data to custom areas.

Please note: the information above has been obtained from sources believed reliable. While we do not doubt its accuracy, we have not verified it and make no guarantee, warranty or representation about it. Posted 11/03/24.



www.hawaiicre.com

VICTOR ARCA YENA, RS-70259

Vice President

808-292-9154

victor@hawaiicre.com

TAYLOR Y. HIGA, RS-86404

Associate

808-260-6441

taylor@hawaiicre.com

CLASS A OFFICE SPACE - URBAN OASIS

QUEEN'S COURT | 800 Bethel Street, Suite 401, Honolulu, HI 96813

4TH FLOOR

SUITE 401

Office: 1,320 SF
Lanai: 187 SF

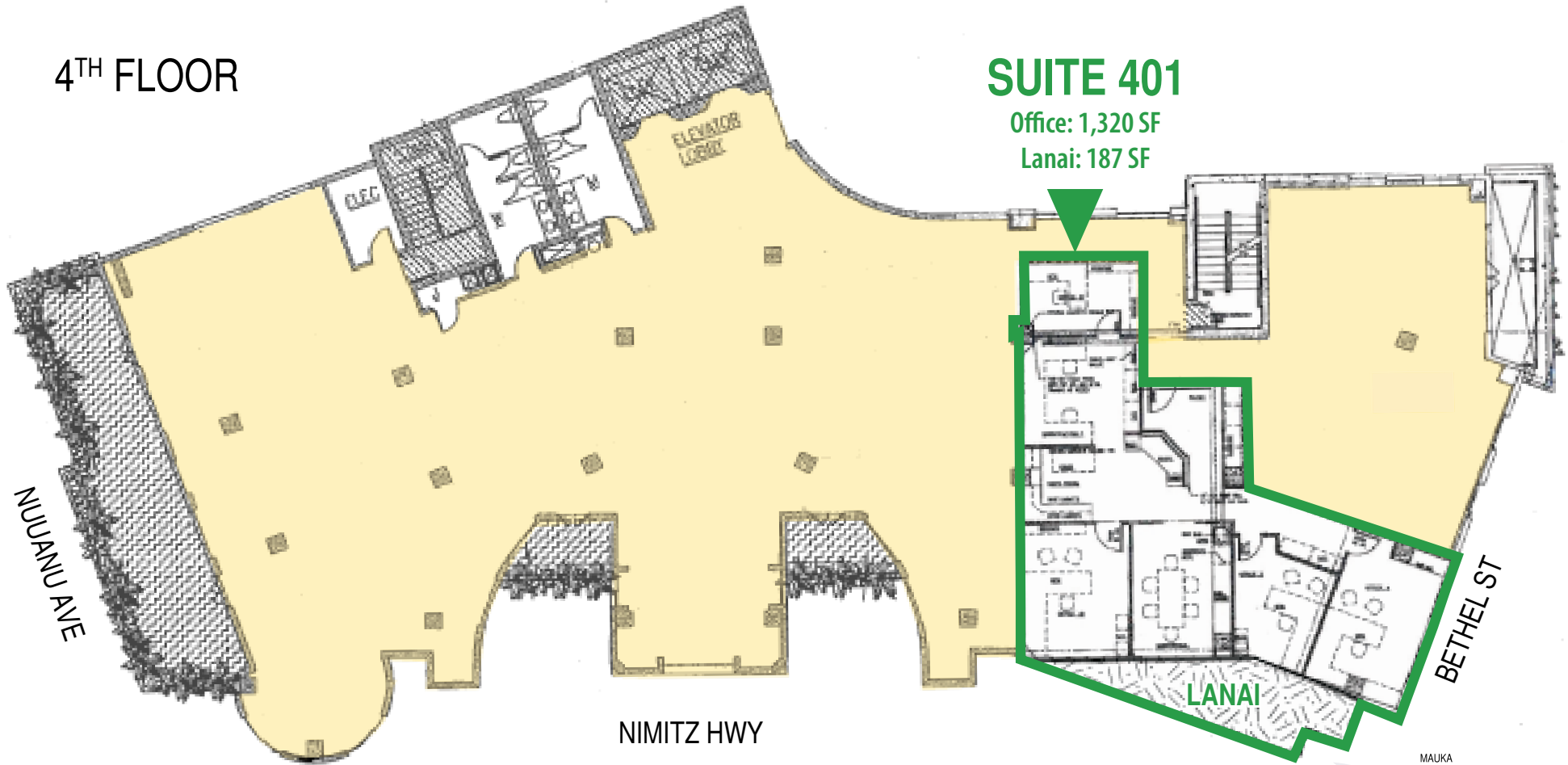

VICTOR ARCA YENA, RS-70259
Vice President
808-292-9154
victor@hawaiiCRE.com

TAYLOR Y. HIGA, RS-86404
Associate
808-260-6441
taylor@hawaiiCRE.com

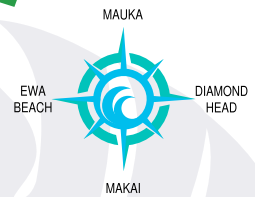

Please note: the information above has been obtained from sources believed reliable. While we do not doubt its accuracy, we have not verified it and make no guarantee, warranty or representation about it. Posted 11/03/24